

PLAN ON MODULAR ROOFLIGHT

Kerb Specification:
X2V kerb constructed from self finish white uPVC

Typical Glazing Specification:
2mm thick polyester powder coated aluminium with 16mm structured polycarbonate internal liner

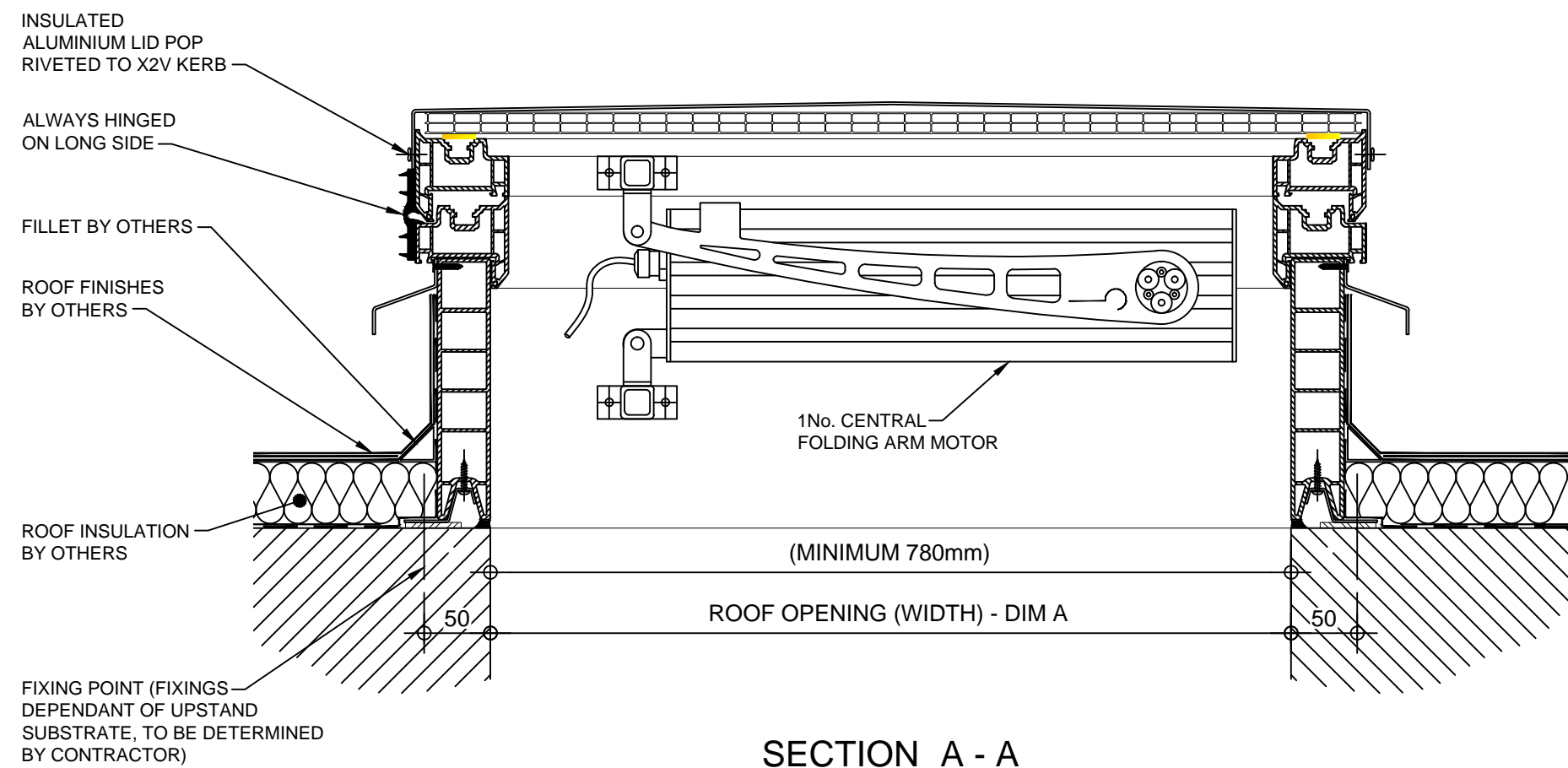

SECTION A - A

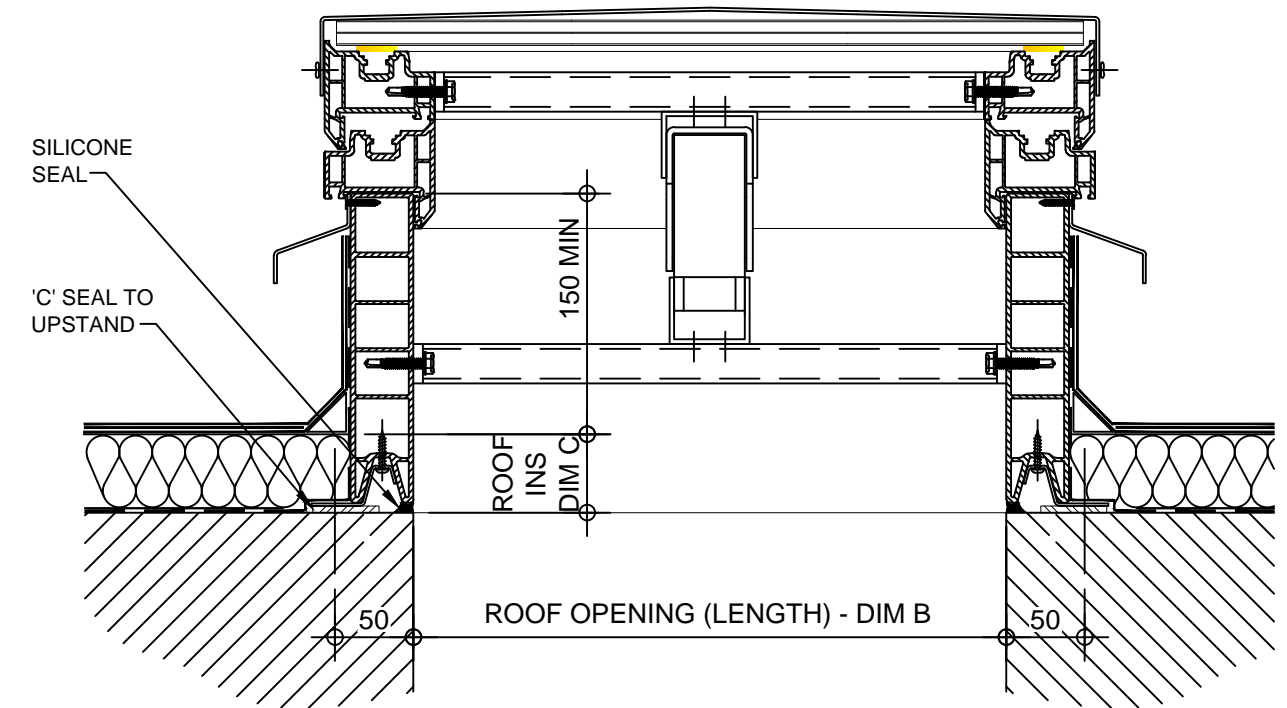

SECTION B - B

REV:	DATE:	DESCRIPTION:	DRN BY	DESCRIPTION:		
1	16.12.13	Updated to show single stack	IW	uPVC X2V kerb direct to roof with 140° electrically operated automatic opening vent and insulated solid lid. Vent actuated via 1No centrally located folding arm motor.		
0	06.12.12	New modular drawings released	IW			
		DRAWN BY:	CREATION DATE:	CHECKED BY:	SCALE(S)	REVISION:
		IW	16-Dec-13	DL	1:5 @ A3	0
				Xtralite (Rooflights) Limited Spencer Road, Blyth Industrial Estate, Blyth, Northumberland, NE24 5TG T:01670 354 157 F:01670 364 875 E:sales@xtralite.co.uk W:www.xtralite.co.uk		DRG No.
						XT-X2V-C-05-140-FA1-ISL



DRG No.
XT-X2V-C-05-140-FA1-ISL