

**Kerb Specification:**  
 X2V kerb constructed from self finish  
 white uPVC

**Typical Glazing Specification:**  
 Outer - 6mm thick clear toughened glass  
 Core - 16mm thick air filled cavity  
 Inner - 6.4mm thick clear laminated low 'E' glass

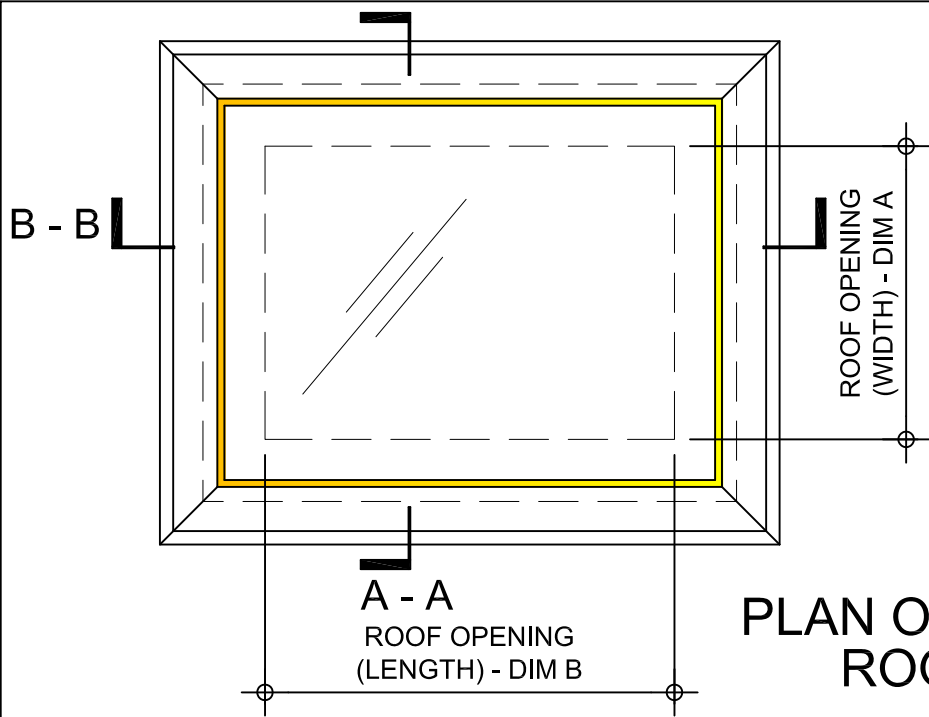

**PLAN ON MODULAR ROOFLIGHT**

GLASS FULLY SILICONE SEALED INTO 'T' FRAME

FILLET BY OTHERS

ROOF FINISHES BY OTHERS

ROOF INSULATION BY OTHERS

FIXING POINT (FIXINGS DEPENDANT OF UPSTAND SUBSTRATE, TO BE DETERMINED BY CONTRACTOR)

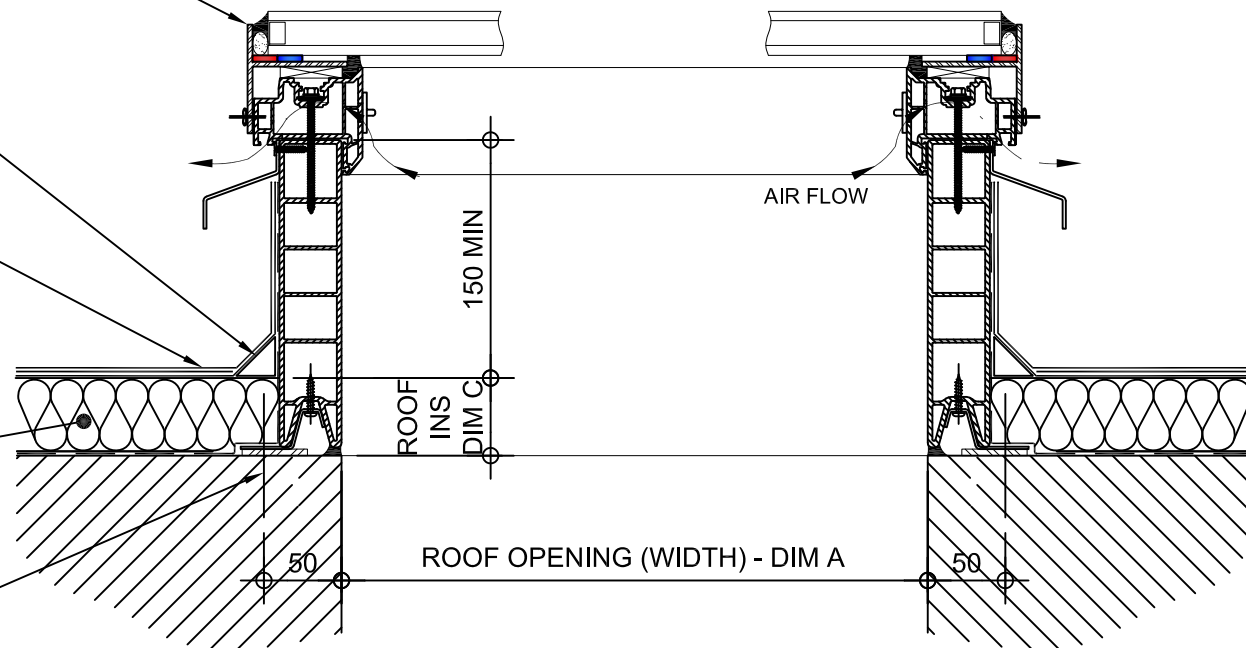

**SECTION A - A**

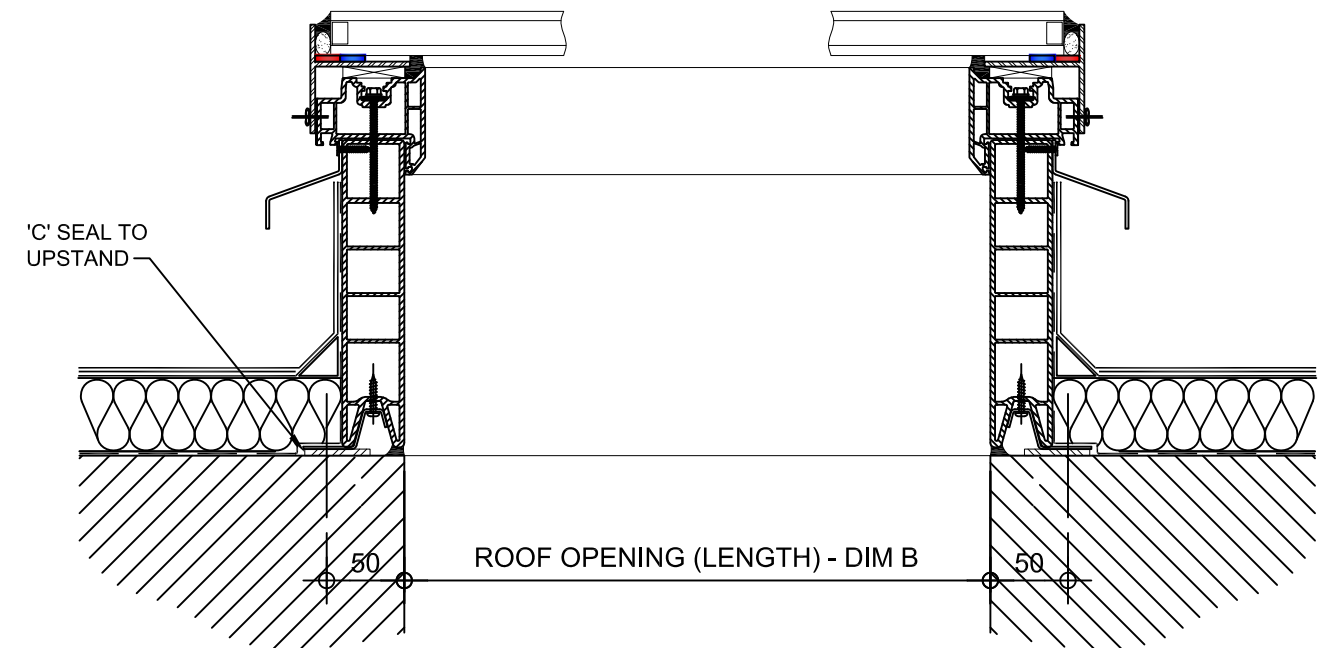

**SECTION B - B**

REV:	DATE:	DESCRIPTION:	DRN BY	DESCRIPTION:		
1	29.11.13	Updated to show single stack	IW	uPVC X2V kerb with hit & miss ventilation, direct to roof with double glazed flat glass top.		
0	06.12.12	New modular drawings released	IW			
		DRAWN BY:	CREATION DATE:	CHECKED BY:	SCALE(S)	REVISION:
		IW	29-Nov-13	DL	1:5 @ A3	1
				<b>Xtralite (Rooflights) Limited</b> Spencer Road, Blyth Industrial Estate, Blyth, Northumberland, NE24 5TG T:01670 354 157 F:01670 364 875 E:sales@xtralite.co.uk W:www.xtralite.co.uk		



DRG No.  
**XT-X2V-C-01-IGLF**