

Kerb Specification:
 X2 kerb constructed from self finish white uPVC

Typical Glazing Specification:
 Outer - 3mm thick clear UV protected polycarbonate
 Mid - 2mm thick clear polycarbonate
 Inner - 3mm thick clear polycarbonate

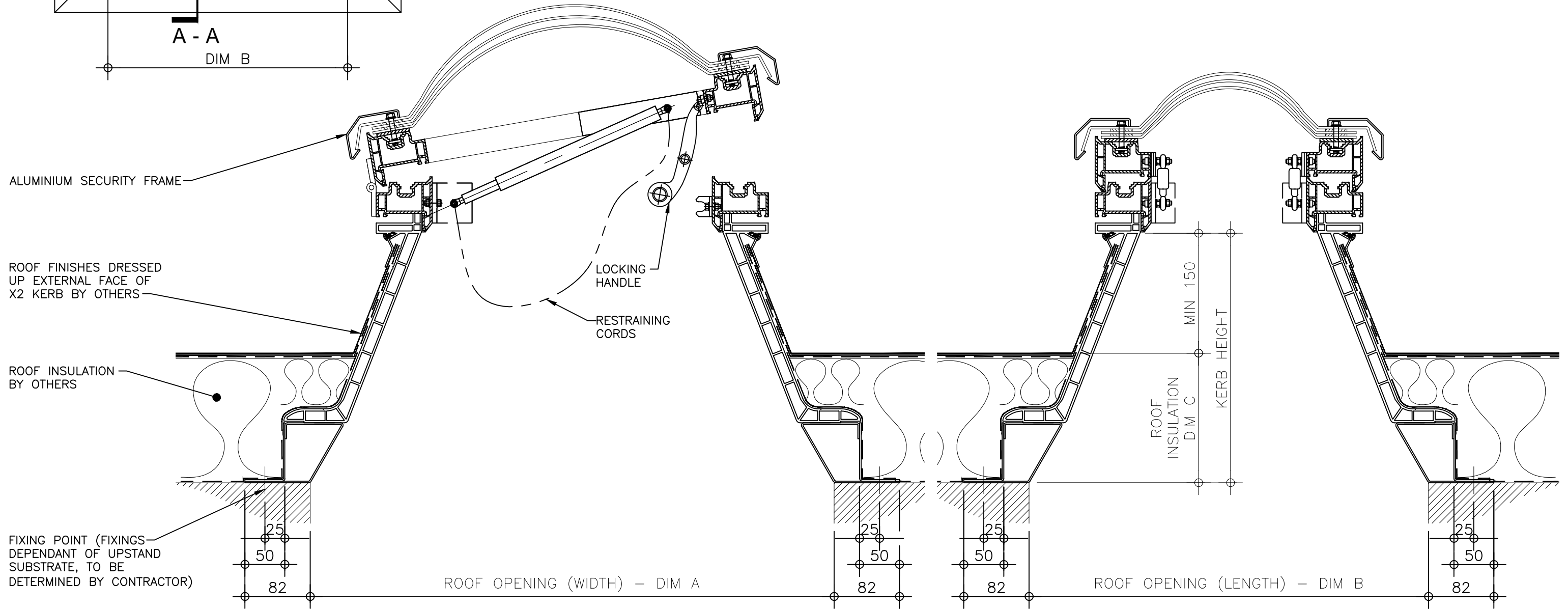
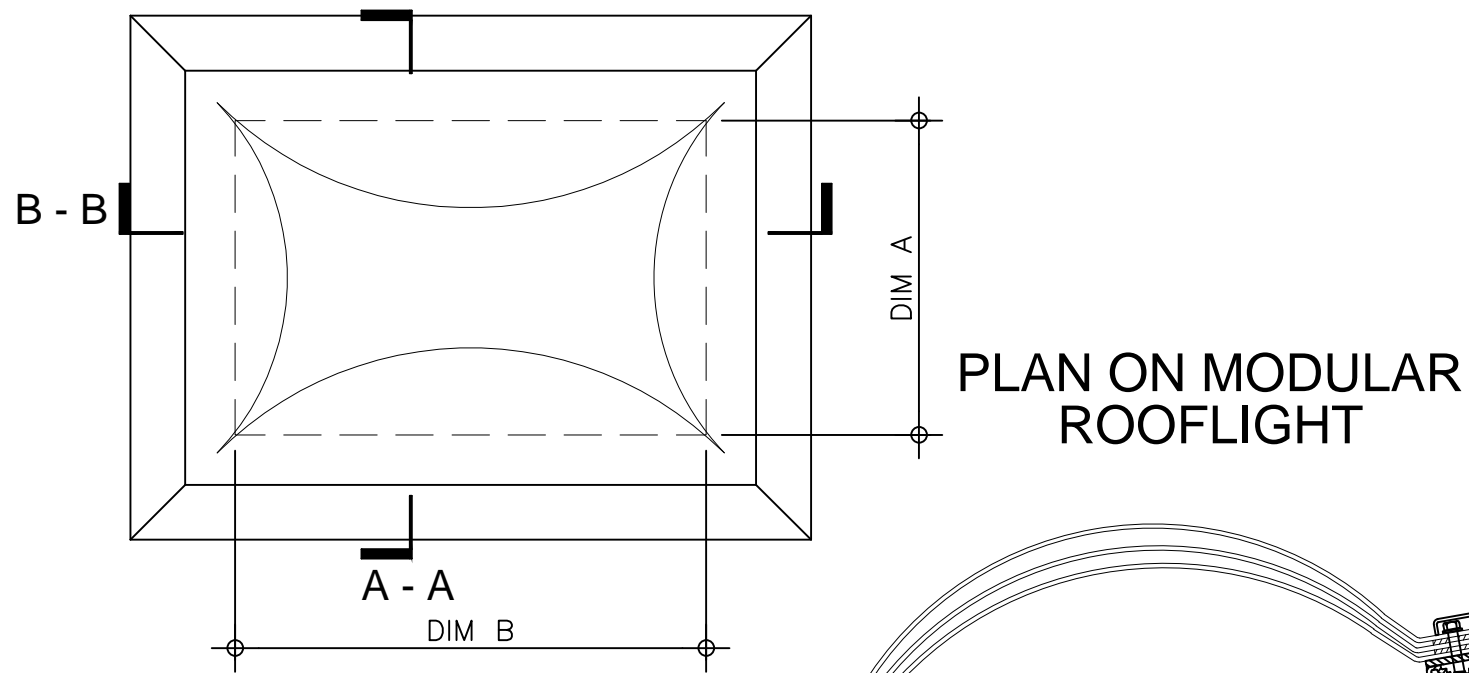

SECTION A - A

SECTION B - B

REV:	DATE:	DESCRIPTION:	DRN BY	DESCRIPTION:
0	23.12.13	New modular drawings released	IW	uPVC access hatch upstand with flexible base kerb, fixed direct to roof, gas spring operated complete with restraining cords, triple skin polycarbonate dome and security frame.
		DRAWN BY:	CREATION DATE:	CHECKED BY:
		IW	23-Dec-13	DL
		SCALE(S)	REVISION:	
		1:5 @ A3	0	
				Xtralite (Rooflights) Limited
				Spencer Road, Blyth Industrial Estate, Blyth, Northumberland, NE24 5TG
				T:01670 354 157 F:01670 364 875 E:sales@xtralite.co.uk W:www.xtralite.co.uk
				Xtralite ROOFLIGHTS
				DRG No.
				XT-X1-A-04G-SF